

High Power Resistors, radial leded

Type: RXG1 (RXG1-T; RXG1-N)

Size : 20 ... 1200 W

Features:

- Power rating up to 1200 W
- Temperature range -55 ... +155°C (extensible up to 275°C)
- High mechanical stability (full-welded structure)
- Adjustable version is available (RXG1-T)
- Non-inductive version is available (RXG1-N)
- Coating: green or grey



Dimensions:

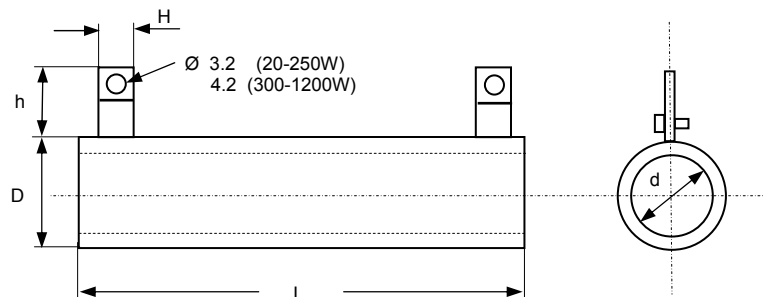

Technical data – depending on size:

Type	Power P ₇₀	Resistance range	L	D	d	H	h
RXG1-20W	20W	5R1-3K3	53	16	8	5	12
RXG1-25W	25W	5R1-3K3	53	18	8	5	12
RXG1-30W	30W	5R1-4K7	73	21	12	5	12
RXG1-40W	40W	5R1-4K7	90	21	12	5	12
RXG1-50W	50W	5R1-5K1	93	29	17	8	16
RXG1-70W	70W	5R1-10K	144	29	17	8	16
RXG1-100W	100W	5R1-12K	175	30	17	8	16
RXG1-150W	150W	5R1-12K	220	30	17	8	16
RXG1-200W	200W	5R1-15K	270	30	17	8	16
RXG1-240W	240W	5R1-18K	220	50	35	10	20
RXG1-250W	250W	5R1-18K	270	50	35	10	20
RXG1-300W	300W	5R1-22K	308	50	35	30	
RXG1-400W	400W	5R1-22K	408	50	35	30	
RXG1-550W	550W	5R1-33K	608	50	35	30	
RXG1-650W	650W	5R1-47K	410	67	40	30	
RXG1-750W	750W	5R1-47K	610	67	40	30	
RXG1-850W	850W	5R1-68K	410	84	50	30	
RXG1-1000W	1000W	5R1-68K	610	84	50	30	
RXG1-1200W	1200W	5R1-68K	615	84	50	30	

Issue 07-2009

High Power Resistors, radial leaded

Type: RXG1 (RXG1-T; RXG1-N)

Size : 20 ... 1200 W

Technical data - general:

Tolerances	$\pm 5\%$, $\pm 2\%$
TCR	± 250 ppm/K
Temperature range	-55°C ... $+155^{\circ}\text{C}$
Short time overload acc. to IEC 60115-1 4.13 (5s @ $2.5 \cdot V_R$)	$\Delta R < 1\%$
Load life acc. to IEC 60115-1 4.25 (1000h @ 70°C)	$\Delta R < 5\%$
Resistance to soldering heat acc. to IEC 60115-1 4.18 (3.5s @ 350°C)	$\Delta R < 1\%$
Vibrations acc. to IEC 60115-1 4.22	$\Delta R < 5\%$

Derating curve:

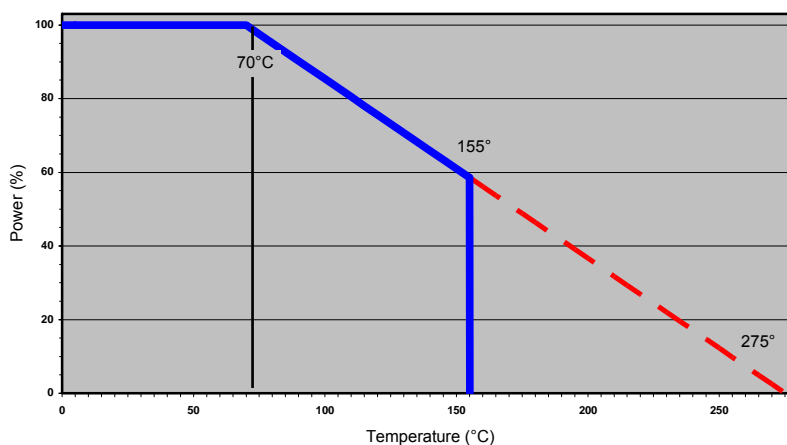

Ordering Data:

Type – style – power - value – tolerance

Example: RXG1-N-400W 100R $\pm 5\%$